

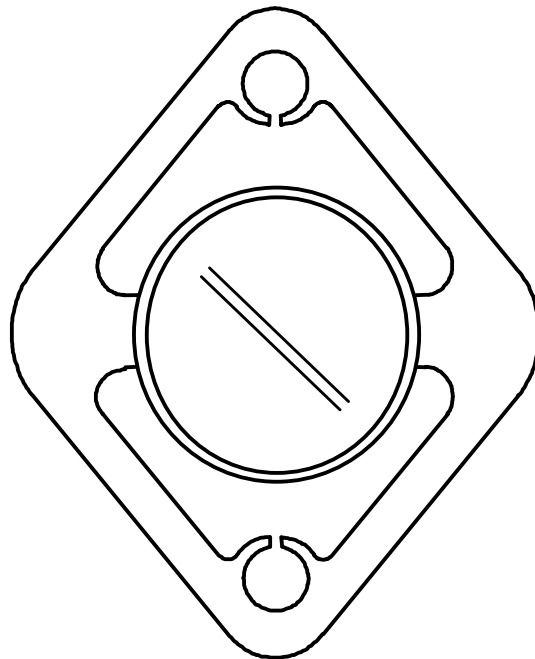

## Mechanical load cell HF 05/ Au Series



**Operating  
and  
maintenance  
manual**

<b>GENERAL WARNING</b>	<b>2</b>
<b>INSTALLATION OF HF 05/Au LOAD CELL</b>	<b>3</b>
<b>CUSTOM CALIBRATION OF HF 05/Au</b>	<b>4</b>

## **GENERAL WARNING**

- 1- Reading and fully understanding the technical data sheets relating to this equipment is essential for the best use of this high technological material that you have received . All the technical data sheets are available on request.**
- 2- Before installing and operating Dynasafe equipment it is essential for the safe and correct operation of the material that this manual be read and fully understood and that all the instructions be followed. This manual should be made available to every operator. Extra copies of this manual will be supplied on request.**
- 3- The installation and the operation Dynasafe equipment should only be carried out in accordance with the appropriate health and safety at work regulations.**
- 4- Never apply to the Dynasafe a load or an effort in excess of the working load limit, and never use it for an operation for which it is not intended.**
- 5- TRACTEL S.A.S declines any responsibility for the consequences of dismantling or altering the machine by any unauthorised person.**
- 6- Dynasafe equipment must not be used in explosive atmospheres.**
- 7- Dynasafe equipment must only be used in a system designed for lifting people after ensuring that the appropriate operating coefficients have been used in accordance with the current regulations.**
- 8- Prior to the use of Dynasafe equipment with complementary equipment relaying the signals to an operating system, the user or installer of this system should carry out a specific risk analysis of the operating functions. The appropriate measures should be taken to obviate risks identified.**

## INSTALLATION OF HF 05/Au LOAD CELL

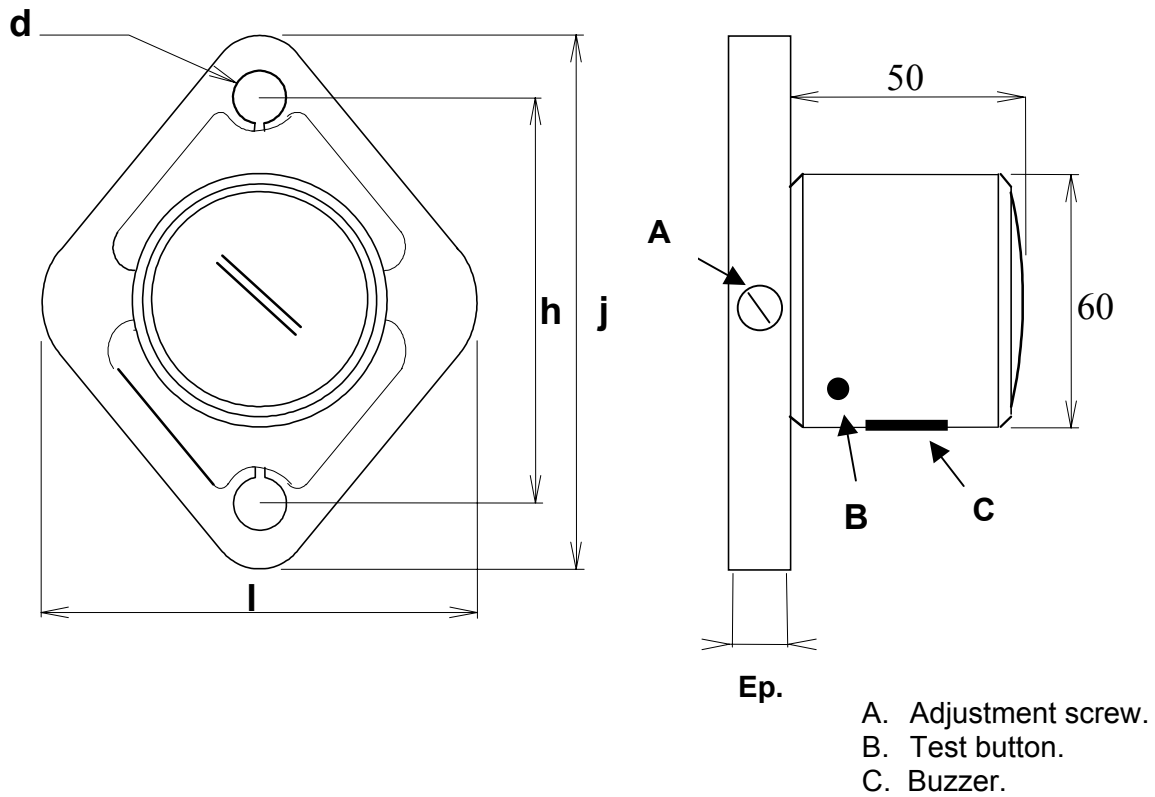

### Characteristics

Code	Models	Cap. Maxi daN	Dimensions in mm				
			d	h	j	l	ep.
38578	HF 05/1/Au	500	12	100	124	100	16
38588	HF 05/2/Au	1250	12	100	124	100	16
38598	HF 05/3/Au	2000	16	100	124	106	16
38608	HF 05/4/Au	3200	20	105	134	108	20
38618	Alarm spare part		Ø 60 mm		H 50 mm		

### Procedure for installing the load cell

Using shackles or forks, insert the load cell into the kinematics line to be controlled. Alarm will turn on when system is overloaded.

## CUSTOM CALIBRATION OF HF 05/Au

Two calibration processes are possible :

### Method n°1

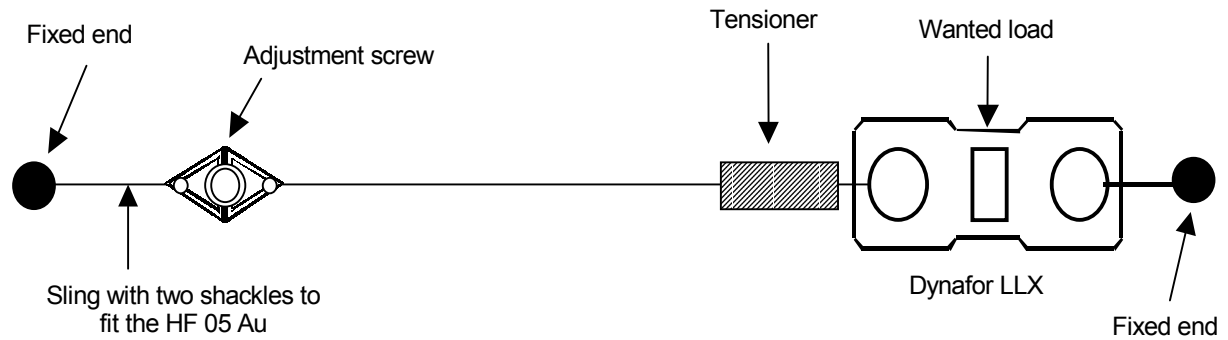

- Create an installation as showed above.
- Using the tensioner, taut the sling at the wanted load. Check the load on the Dynafor.
- Turn the adjustment screw till you activate the alarm.  
Clockwise : Lowering the trip point value.  
Anti-clockwise : Increasing the trip point value

### Method n°2

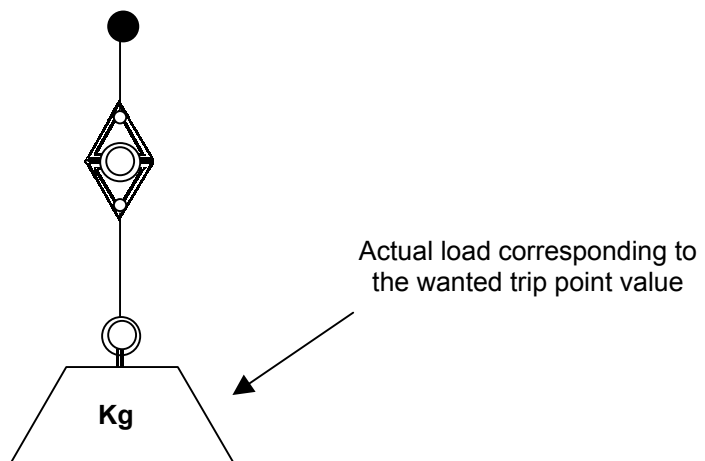

- Create an installation as showed above.
- Turn the adjustment screw till you activate the alarm.  
Clockwise : Lowering the trip point value.  
Anti-clockwise : Increasing the trip point value

**NOTES :**